

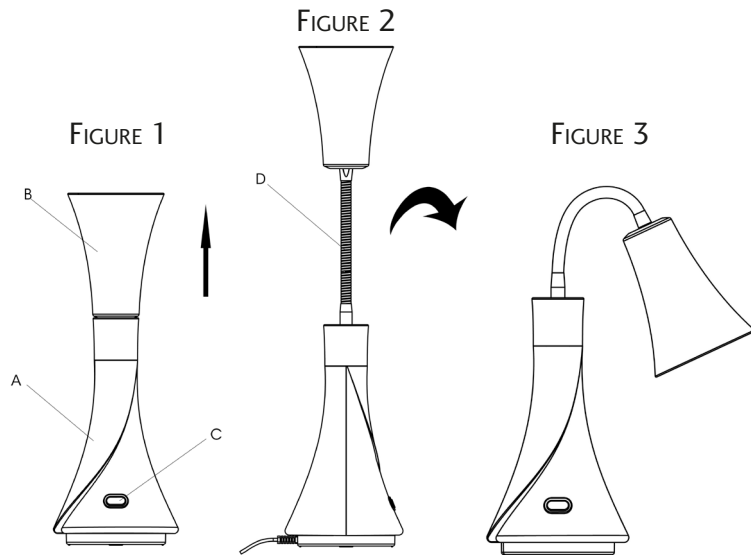

ENGLISH

Tulip Desk Lamp



15w Tulip Desk Lamp

15CVTSV8 15CVTCH8

PL7966

REV092513

CONGRATULATIONS!

You've purchased the finest in natural lighting technology with your new OttLite® product.

PRODUCT REGISTRATION FORM

Please complete the enclosed Product Registration Form and return it today by mail, or register online by going to: <http://warranty.OttLite.com>.

WARNING: To prevent electric shock, make sure the lamp is not plugged in until all assembly steps are complete.

LAMP ASSEMBLY

1. Remove lamp from packing placing lamp body (A) base flat on a steady surface.
2. Refer to BULB INSTALLATION AND REMOVAL to install bulb in lamp.
3. Plug the cord into a standard 120Vac outlet.
4. To turn the lamp on or off depress pushbutton switch (C).
5. To extend the shade (B), grasp the body (A) of the lamp with one hand and the base of shade (B) with the other hand, then pull the shade straight out of the base until it is fully extended (Figure 2). DO NOT FORCE the shade beyond where it stops to avoid damaging the lamp.
6. To position the shade simply bend the flex neck (D) (Figure 3) as needed to point the light. To avoid damaging the lamp, DO NOT FORCE the flex neck into a sharp bend.
7. To return the shade (B) to its retracted position, straighten the flexible neck (D) and shade to a vertical position (Figure 2), grasp the flexible neck a few inches above the lamp body (A) and begin pushing the flexible neck into the lamp body. The shade (B) may be held to push the last few inches of the flexible neck into the lamp body.

BULB INSTALLATION AND REMOVAL

1. Make sure that the lamp is not plugged into an electrical socket.
2. If the lamp has been in use, allow it to cool approximately 5 minutes before proceeding.
3. To install the bulb in the socket, thread the base of the bulb into the socket turning clockwise until snug.

CAUTION: DO NOT over tighten the bulb. Over tightening the bulb may make removal difficult, damage the lamp, or damage the bulb.

4. To remove a bulb already installed in the lamp, unthread the bulb from the socket turning counterclockwise to loosen.

DO NOT allow glass part of the bulb to strike any hard surface as it may break.

Please note that in operation, OttLite® tubes are not dimmable.

Enjoy your OttLite® Tulip Desk Lamp!

This lighting system is designed for use with OttLite® type  bulbs (style number ED15-S). Use of other products voids the warranty and may result in damage to the lighting system.

CAUTION! IMPORTANT SAFETY INSTRUCTIONS:

THIS PORTABLE LAMP HAS A POLARIZED PLUG (ONE BLADE IS WIDER THAN THE OTHER) AS A FEATURE TO REDUCE THE RISK OF ELECTRIC SHOCK. THIS PLUG WILL FIT IN A POLARIZED OUTLET ONLY ONE WAY. IF THE PLUG DOES NOT FIT FULLY IN THE OUTLET, REVERSE THE PLUG. IF IT STILL DOES NOT FIT, CONTACT A QUALIFIED ELECTRICIAN. NEVER USE WITH AN EXTENSION CORD UNLESS PLUG CAN BE FULLY INSERTED. DO NOT ALTER THE PLUG.

CAUTION: TO PREVENT ELECTRIC SHOCK, MATCH WIDE BLADE OF PLUG TO WIDE SLOT, FULLY INSERT.

CAUTION: IF THE EXTERNAL FLEXIBLE CABLE OR CORD OF THIS LUMINAIRE IS DAMAGED, IT SHALL BE EXCLUSIVELY REPLACED BY THE MANUFACTURER OR ITS SERVICE AGENT OR A SIMILAR QUALIFIED PERSON IN ORDER TO AVOID A HAZARD. INDOOR USE ONLY.